

**Request for Qualifications
Open-Air Information Center for Port St. Joe Historic Downtown District**

Port St. Joe Redevelopment Agency
406 Marina Drive
Port St. Joe, FL 32456
850-229-6899
www.PSJRA.com
Gail@PSJRA.com

The RFQ process is selected for this project due to the requirement for innovative design and engineering solutions on an existing deck, limited by both size and physical location. Multiple options for achieving the desired results are possible, and to achieve the most aesthetically pleasing and functional design within the physical parameters requires highly qualified professionals.

The Open-Air Information Center serves a critical purpose for the Port St. Joe Historic Downtown Shopping District: it will provide travelers on US-98 a vision of retail opportunities one block to the east—the center of the business district that is not visible from the highway. It will also serve to inform passers-by of city-wide events and tourism opportunities. This project is a collaborative effort between the Port St. Joe Redevelopment Agency, the City of Port St. Joe, the Gulf County Tourist Development Council, and the Gulf County Chamber of Commerce.

The Scope of Work shall include design, signed/sealed engineering, and construction plans for an open-air, public signage system to clearly and calculatingly attract travelers on US-98 to stop and explore the shopping and tourist-related opportunities in Port St. Joe and Gulf County. **The system will be installed on an existing wood deck that covers an existing storm-water retention pond.** The existing deck is approximately 1400 square feet and constructed with the following specifications:

- 6x6 vertical pilings 10-feet on center, encased in concrete, with a minimum of 3 feet depth below grade.
- 2x12 structural framing.
- 2x10 joist framing.
- 2x6 top deck boards.
- All materials are pressure treated.
- All bolts are 5/8 inch with washers and nuts.

Refer to exhibit A for project location map.
Refer to exhibit B for deck conceptual plan.
Refer to exhibit C for photos of the existing deck.
Refer to exhibit D for examples of existing local branding.

The Port St. Joe Redevelopment Agency seeks highly qualified professionals with a diversity of skill sets to perform this task. Qualified firms/individuals will be ranked on the following:

- Professional qualifications and experience of firms/teams/individuals in
 - Local Business Wayfinding and Community Identification
 - Context Sensitive Design
 - Highway and Scenic Highway Projects
 - Fabrication of Similar Projects
 - Stormwater Structures and Permitting
 - Electrical Engineering
- Similar project experience
- Project work plan demonstrating how the project will be accomplished
- Order of magnitude construction budget

Proposals shall include, at a minimum, the following elements, in this order:

- A. INTRODUCTION - An introductory letter on firm letterhead indicating name of firm, contact person, phone, fax, e-mail, type of business entity, and a short statement summarizing the strengths of the firm/team as it relates to this project.
- B. EXPERIENCE - A description of the firm's relevant experience and capabilities, with a description of comparable projects including, contact names, phone numbers, dates, budget and outcome.
- C. PROJECT TEAM - Project team organization, names and resumes of team members including those consultants who will manage and perform the work.
- D. WORK PLAN - A clear description of how the consultant will complete the scope of services and the format to be used for communication and presentation. This should include but not be limited to:
 - Description of base information needed and provided for the completion of the project.
 - A description of the specific approach to the project, and the strategy in establishing priorities, managing conflicting opinions and obtaining consensus.

Sealed bids must be delivered to Gail Alsobrook, Executive Director of the Port St. Joe Redevelopment Agency, c/o City of Port St. Joe, 305 Cecil G. Costin, Sr., Boulevard, Port St. Joe, FL 32456. Bids must be received **by 2 PM EDT on Thursday, February 13, 2014.** The qualifications of respondents will be ranked by the Port St. Joe Redevelopment Agency's Executive Director and Board of Directors, who shall also conduct negotiations with the top-ranked firms to arrive at the award of the contract. Final approval rests with the Port St. Joe City Commission.

The Port St. Joe Redevelopment Agency and/or the City of Port St. Joe reserve the right to reject any and all bids. All bidders shall comply with all applicable state and local laws concerning licensing registration and regulation of contractors doing business in the State of Florida.

Exhibit A—Project Location

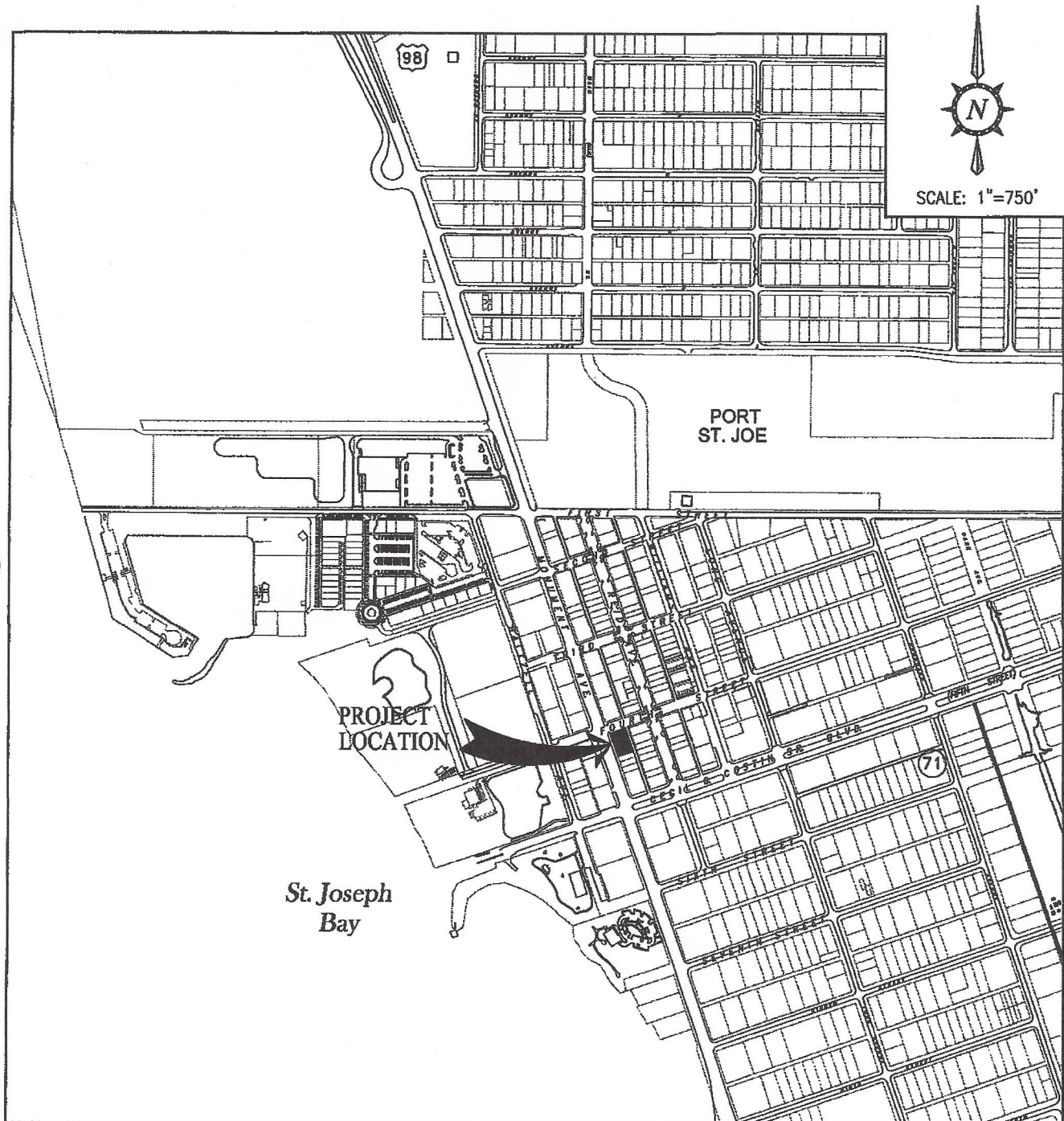

PREBLE-RISH INC
CONSULTING ENGINEERS AND SURVEYORS
CIVIL • SURVEYING • SITE PLANNING

324 MARINA DRIVE
PORT ST. JOE, FL 32456
(850) 227-7200

203 ABERDEEN PARKWAY
PANAMA CITY, FL 32405
(850) 522-0844

877 COUNTY ROAD 353
SANTA ROSA BEACH, FL 32450
(850) 267-0750

LOCATION MAP

BILLY JOE RISH PARKING LOT
CITY OF PORT ST. JOE
GULF COUNTY, FLORIDA

DATE:
Sept. 2010
SCALE:
AS NOTED
DRAWN:
L. EVERS
CHECKED:
C. SMALLWOOD

EB# 0008165

PROJECT NO.

019.179

SHEET

2

Exhibit B—Deck Conceptual Plan

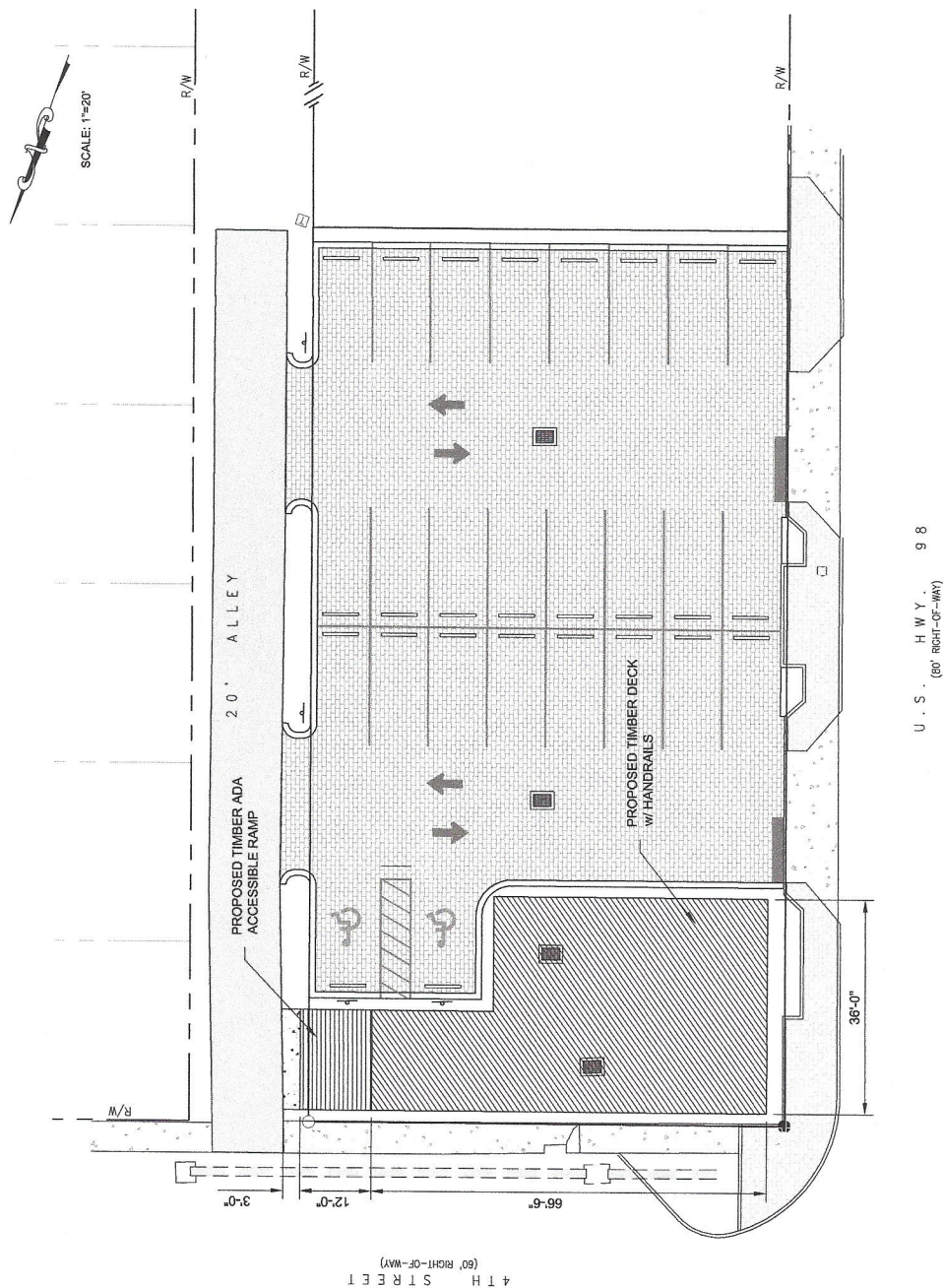

DECK SECTION (TYPICAL)

SCALE: N.T.S.

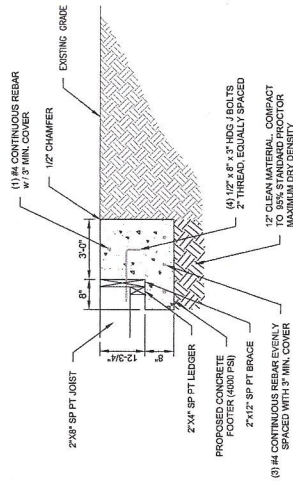

DETAIL - CONCRETE ANCHOR

SCALE: N.T.S.

PREBLE-RISH INC. ALL RIGHTS RESERVED. BY PRINTING OF THIS DOCUMENT YOU AGREE TO RELEASE PREBLE-RISH INC. FROM WITHOUT FURTHER WRITTEN AUTHORIZATION OF PREBLE-RISH INC.			REVISIONS:			TIMBER DECK - CONCEPTUAL PLAN BILLY JOE RISH PARKING LOT			PREBLE-RISH INC. CONSULTING ENGINEERS AND SURVEYORS CIVIL SURVEYING • SITE PLANNING 324 MARIONA DRIVE NORFOLK, VIRGINIA 23502 PHONE 757-227-2000 FAX 757-227-2001 5305 SCHOON HOPKINS DRIVE, SUITE 102 NORFOLK, VIRGINIA 23509 PHONE 757-227-2000 FAX 757-227-2001			CITY OF PORT ST. JOE GULF COUNTY, FLORIDA			DATE: November 2012 SCALE: 1"=20' DRAWN: C. RISH CHECKED: C. RISH IN CHARGE: C. RISH SHEET C1			PROJECT NO. 019.179 DATE 0000163		
No.			DATE			APPR.														
1																				
2																				
3																				
4																				
5																				

Exhibit C—Photos of Existing Deck



Southeast View (Historic Shopping District in background)



Southwest View from alley (US-98 in background)



West View from alley (US-98 in background)



Northeast View from US-98 (Historic District in background)



Northwest View from parking lot (US-98 in background)

Exhibit D—Photos of Existing Branding

